

H SERIES

H 4200



Ordering-Example:

Special Sizes Available On Request.

ISO 11901 - 1	VDI 3003 Blatt 4	B2 4008 (BMW)	075.90.65 (FCA)
39D 838 (VW)			

OSAS + OSM = **OVER STROKE ACTIVE SAFETY** + **OVER STROKE MARKER**

ACTIVE SAFETY

The new code will be supplied only when the old will be out of stock

easq MANIFOLD

* F_{1i} = Isothermal end force at 100% Cu

** F_{1p} = Polytrophic end force at 100% Cu

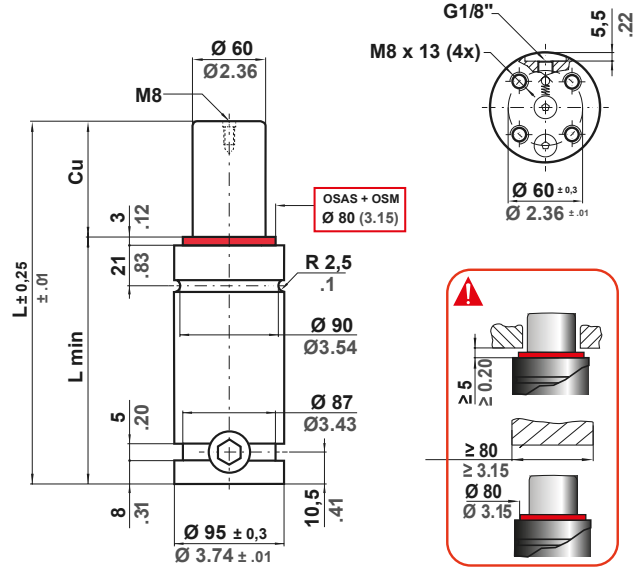

		ΔP ± 0,33 %/°C	P max 150 bar 2175 psi	P min 20 bar 290 psi	S 28,27 cm ² 4,382 in ²	SPM ~ 15 - 100 (at 20°C)	Max Speed 1,8 m/s 70,8 in/s	Maintenance kit 39BMH04200DH
--	--	---------------------------	-------------------------------------	-----------------------------------	--	---------------------------------------	--	--

CODE PHASING OUT from 04/2021	NEW	Cu		L		L min		F0 Initial force		F1i End force *		F1p End force **		V0		~Kg	~lb	PED 2014/68/EU	
		mm	inch	mm	inch	mm	inch	daN	lb	daN	lb	daN	lb	cm ²	in ²				
H 4200 - 025 - D	H 4200 - 025 - E	25	0.98	170	6.69	145	5.71	4240	9532	± 5%	5877	13212	6846	15389	295	17.99	5,76	12.70	✓
H 4200 - 038 - D	H 4200 - 038 - E	38	1.50	196	7.72	158	6.22				6312	14190	7526	16919	378	23.09	6,12	13.49	✓
H 4200 - 050 - D	H 4200 - 050 - E	50	1.97	220	8.66	170	6.69				6601	14840	7987	17955	455	27.79	6,45	14.22	✓
H 4200 - 063 - D	H 4200 - 063 - E	63	2.48	246	9.70	183	7.20				6838	15371	8369	18815	539	32.88	6,80	14.99	✓
H 4200 - 075 - D	H 4200 - 075 - E	75	2.95	270	10.63	195	7.68				7008	15755	8648	19441	616	37.58	7,13	15.72	✓
H 4200 - 080 - D	H 4200 - 080 - E	80	3.15	280	11.02	200	7.87				7069	15892	8748	19666	648	39.54	7,27	16.03	✓
H 4200 - 100 - D	H 4200 - 100 - E	100	3.94	320	12.60	220	8.66				7269	16342	9078	20408	777	47.38	7,76	17.11	✓
H 4200 - 125 - D	H 4200 - 125 - E	125	4.92	370	14.57	245	9.65				7447	16742	9374	21074	938	57.22	8,45	18.63	✓
H 4200 - 150 - D	H 4200 - 150 - E	150	5.91	420	16.54	270	10.63				7581	17043	9599	21578	1098	67.02	9,13	20.13	✓
H 4200 - 160 - D	H 4200 - 160 - E	160	6.30	440	17.32	280	11.02				7656	17211	9724	21861	1156	70.56	9,40	20.72	✓
H 4200 - 175 - D	H 4200 - 175 - E	175	6.89	470	18.50	295	11.61	7712	17338	9820	22077	1253	76.44	9,82	21.65	✓			
H 4200 - 200 - D	H 4200 - 200 - E	200	7.87	520	20.47	320	12.60	7791	17515	9953	22376	1413	86.24	10,50	23.15	✓			
H 4200 - 250 - D	H 4200 - 250 - E	250	9.84	620	24.41	370	14.57	7908	17777	10151	22821	1734	105.83	11,87	26.17	✓			
H 4200 - 300 - D	H 4200 - 300 - E	300	11.81	720	28.35	420	16.54	8123	18260	10519	23648	2016	123.02	13,24	29.19	✓			

