

KE SERIES

KE 750



Ordering-Example:

Special Sizes Available On Request.



ACTIVE SAFETY

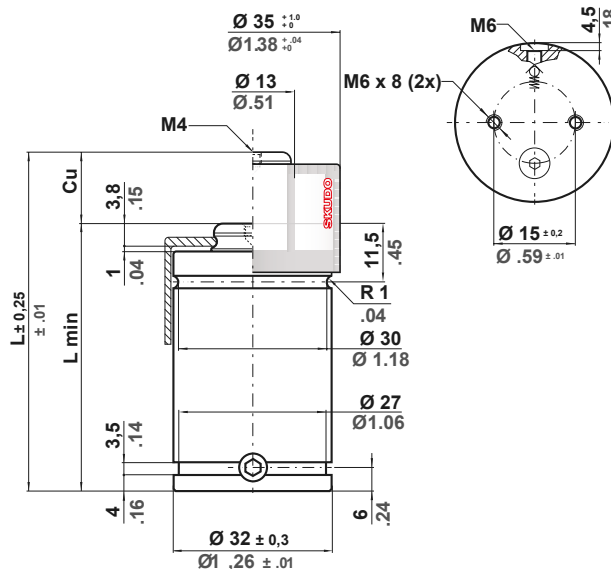

The new code will be supplied only when the old will be out of stock

easu
MANIFOLDS

* F_{1i} =
Isothermal
end force
at 100% Cu

** F_{1p} =
Polytropic
end force
at 100% Cu

	0 - 80 °C 32 - 176 °F	ΔP ± 0,33 %/°C	P max 150 bar 2175 psi	P min 20 bar 290 psi	S 4,91 cm ² 0,761 in ²	SPM ~ 50 - 100 (at 20°C)	Max Speed 0,8 m/s 31,5 in/s	Maintenance kit 39BMKE00750B
--	--------------------------	---------------------------	-------------------------------------	-----------------------------------	---	---------------------------------------	--	--

CODE	Cu		L		L min		F0 Initial force		F1i End force *		F1p End force **		V0		PED 2014/68/EU		
	mm	inch	mm	inch	mm	inch	daN	lb	daN	lb	daN	lb	cm ³	in ³	~Kg	~lb	
KE 750 - 006 - B	6	0.24	63	2.48	57	2.24	740	1664	1214	2729	1497	3365	8,6	0.52	0,23	0.51	✓
KE 750 - 010 - B	10	0.39	75	2.95	65	2.56	± 5% 150 bar 2175 psi +20 °C +68 °F		1316	2958	1666	3745	12,7	0.78	0,25	0.55	✓
KE 750 - 016 - B	16	0.63	93	3.66	77	3.03			1395	3136	1800	4047	18,9	1.15	0,29	0.64	✓
KE 750 - 025 - B	25	0.98	120	4.72	95	3.74			1453	3267	1901	4273	28,2	1.72	0,33	0.73	✓
KE 750 - 032 - B	32	1.26	140	5.51	108	4.25			1499	3370	1980	4452	34,9	2.13	0,37	0.82	✓
KE 750 - 040 - B	40	1.57	165	6.50	125	4.92			1498	3369	1980	4450	43,7	2.67	0,42	0.92	✓
KE 750 - 050 - B	50	1.97	195	7.68	145	5.71			1515	3405	2008	4515	54,0	3.30	0,47	1.04	✓

