

MQ SERIES

MQ 700



Ordering-Example:

Special Sizes Available On Request.

ACTIVE SAFETY



OSAS



USAS

* F_{1i} =

Isothermal end force at 100% Cu

** F_{1p} =

Polytropic end force at 100% Cu

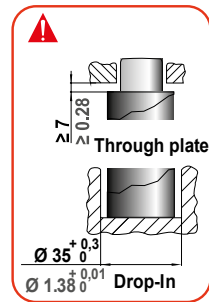
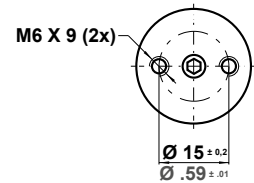
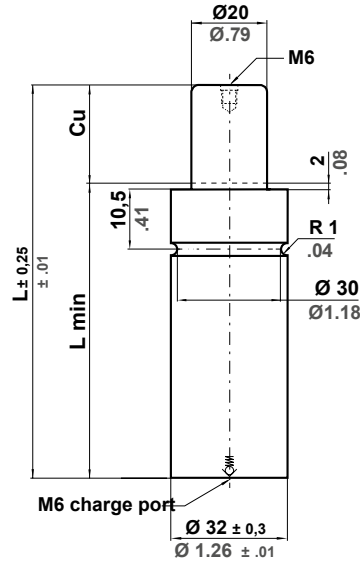

		0 - 80 °C 32 - 176 °F	ΔP ± 0.33 %/°C	P max 210 bar 3045 psi	P min 20 bar 290 psi	S 3.14 cm ² 0.487 in ²	SPM ~ 40 - 80 (at 20°C)	Max Speed 1.6 m/s 62.9 in/s	Maintenance kit Disposable
--	--	--------------------------	---------------------------	-------------------------------------	-----------------------------------	---	--------------------------------------	--	--------------------------------------

CODE	Cu		L		L min		F0 Initial force		F1i End force *		F1p End force **		V0		PED 2014/68/EU		
	mm	inch	mm	inch	mm	inch	daN	lb	daN	lb	daN	lb	cm ³	in ³	~Kg	~lb	
MQ 700 - 010 - A	10	0.39	75	2.95	65	2.56	± 5% 210 bar 3045 psi +20 °C +68 °F	1484	1020	2293	1158	2603	11.3	0.69	0.29	0.60	✓
MQ 700 - 015 - A	15	0.59	85	3.35	70	2.76			1120	2517	1293	2907	14.4	0.88	0.31	0.68	✓
MQ 700 - 020 - A	20	0.79	95	3.74	75	2.95			1193	2683	1395	3135	17.5	1.07	0.33	0.73	✓
MQ 700 - 025 - A	25	0.98	105	4.13	80	3.15			1250	2810	1473	3312	20.6	1.26	0.35	0.77	✓
MQ 700 - 032 - A	32	1.26	120	4.72	88	3.46			1288	2896	1527	3432	25.5	1.56	0.38	0.84	✓
MQ 700 - 038 - A	38	1.50	135	5.31	97	3.82			1272	2861	1505	3383	30.7	1.87	0.41	0.90	✓
MQ 700 - 045 - A	45	1.77	150	5.91	105	4.13			1297	2916	1539	3461	35.6	2.17	0.44	0.97	✓
MQ 700 - 050 - A	50	1.97	160	6.30	110	4.33			1297	2972	1575	3540	38.7	2.36	0.46	1.01	✓
MQ 700 - 056 - A	56	2.20	175	6.89	119	4.69			1307	2937	1575	3490	43.9	2.68	0.49	1.08	✓
MQ 700 - 063 - A	63	2.48	195	7.68	132	5.20			1266	2846	1496	3363	51.2	3.12	0.53	1.17	✓
MQ 700 - 080 - A	80	3.15	230	9.06	150	5.91	1314	2954	1563	3515	62.3	3.80	0.60	1.32	✓		

