

## S SERIES

S 3000



Ordering-Example:

Special Sizes Available On Request.

EM24.54.700 (Renault)

**OSAS + OSM**

OVER STROKE = ACTIVE SAFETY + OVER STROKE MARKER



**ACTIVE SAFETY**



OSAS



USAS



OPAS

The new code will be supplied only when the old will be out of stock



\*  $F_{1i}$  = Isothermal end force at 100% Cu

\*\*  $F_{1p}$  = Polytropic end force at 100% Cu

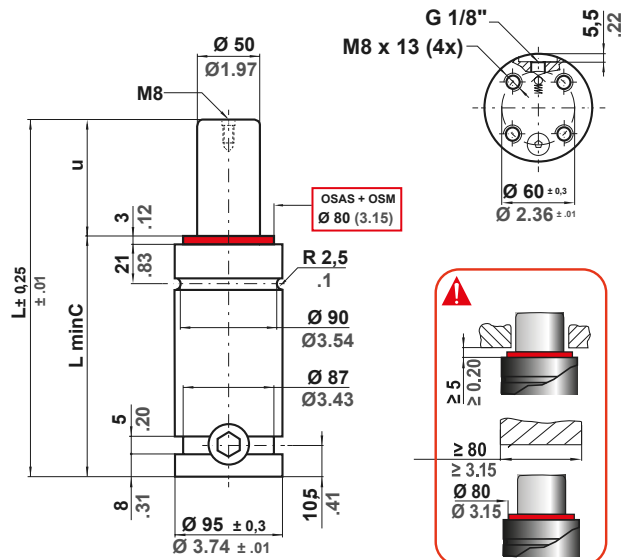

		0 - 80 °C 32 - 176 °F	$\Delta P$ ± 0.33 %/°C	<b>P max</b> 150 bar 2175 psi	<b>P min</b> 20 bar 290 psi	<b>S</b> 19.63 cm <sup>2</sup> 3.043 in <sup>2</sup>	<b>SPM</b> ~ 15 - 60 (at 20°C)	<b>Max Speed</b> 1.8 m/s 70.8 in/s	<b>Maintenance kit</b> 39BMS03000B
--	--	--------------------------	---------------------------	-------------------------------------	-----------------------------------	--	--------------------------------------	--	---------------------------------------

CODE PHASING OUT from 04/2021	NEW	Cu		L		L min		F0 Initial force		F1i End force *		F1p End force **		V0		PED 2014/68/EU		
		mm	inch	mm	inch	mm	inch	daN	lb	daN	lb	daN	lb	cm <sup>3</sup>	in <sup>3</sup>	~Kg	~lb	✓
S 3000 - 025 - A	S 3000 - 025 - B	25	0.98	120	4.72	95	3.74	2945	6621	4562	10256	5511	12390	160	9.73	4,13	9.11	✓
S 3000 - 038 - A	S 3000 - 038 - B	38	1.50	146	5.75	108	4.25	± 5% 150 bar 2175 psi + 20 °C +68 °F		4779	10744	5862	13178	223	13.63	4,61	10.16	✓
S 3000 - 050 - A	S 3000 - 050 - B	50	1.97	170	6.69	120	4.72			4900	11016	6060	13623	282	17.21	5,04	11.11	✓
S 3000 - 063 - A	S 3000 - 063 - B	63	2.48	196	7.72	133	5.24			4988	11214	6205	13949	346	21.10	5,51	12.15	✓
S 3000 - 080 - A	S 3000 - 080 - B	80	3.15	230	9.06	150	5.91			5066	11389	6334	14239	429	26.19	6,13	13.51	✓
S 3000 - 100 - A	S 3000 - 100 - B	100	3.94	270	10.63	170	6.69			5128	11528	6437	14470	527	32.17	6,86	15.12	✓

