

N 51

Insulating Board $P = 600 \text{ N/mm}^2$

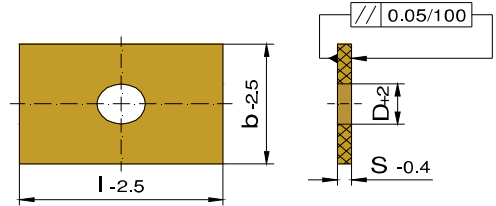
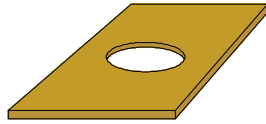

Ordering-Example:

1 Piece N51 95/95/3/22

Special Sizes Available On Request

Application Temperature: 200°C
Thermal Conductivity: $0,19 \text{ W/mk}$

Dense: $1,9 \text{ g/cm}^3$

b	l	S	D	€	
95	95	3	22		
100	130		22		
156	156		90		
	196		90		
	246		90		
190	246		90		
196	196		90		
	246		90		
206	156		90		
	196		90		
95	95		5	22	
100	130			22	
156	156	90			
	196	90			
	246	90			
	296	90			
	396	90			
190	246	90			
	296	90			
196	196	90			
	246	90			
	296	90			
206	156	90			
	196	90			
	246	90			
218	246	90			
	296	90			
	346	90			
246	156	90			
	196	90			
	246	90			
	296	90			
254	246	90			
276	246	90			

b	l	S	D	€
126	156	6	90	
156	246		90	
	156		90	
	196		90	
	206		90	
	246		90	
	296		90	
196	346		90	
	396		90	
	446		90	
	196		90	
	206		90	
	246		90	
216	246		90	
	296		90	
	396		90	
246	246		90	
	266		90	
	296		90	
	346		90	
	396		90	
	446		90	
266	496		90	
	546		90	
	596	90		
	296	90		

N 51

Insulating Board $P = 600 \text{ N/mm}^2$

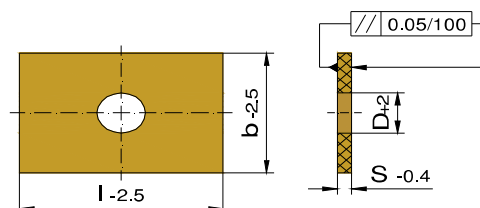
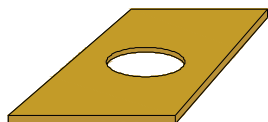

Ordering-Example:

1 Piece N51 196/296/7/90

Special Sizes Available On Request

Application Temperature: 200°C
Thermal Conductivity: $0,19 \text{ W/mk}$

Dense: $1,9 \text{ g/cm}^3$

b	l	S	D	€
196	296	7	90	
	346		90	
	396		90	
	446		90	
218	396		90	
246	246		90	
	296		90	
	346		90	
	396		90	
	446		90	
254	246		90	
276	296		90	
296	296		90	
	346		90	
	396	90		
	446	90		
346	346	90		
	396	90		
	446	90		
	496	90		
	546	90		
396	396	90		
	446	90		
	496	90		
	546	90		
496	546	90		
	596	90		
296	296	8	90	
	346		90	
	396		90	
	446		90	
	496		90	
	546		90	
	596		90	
	646		90	
	696		90	

b	l	S	D	€
346	346	8	90	
	396		90	
	446		90	
	496		90	
	546		90	
	596		90	
	646		90	
	696		90	
	796		90	
396	396	90		
	446	90		
	496	90		
	546	90		
	596	90		
	646	90		
	696	90		
446	446	90		
	496	90		
	546	90		
	596	90		
	646	90		
	696	90		
	796	90		
496	496	90		
	546	90		
	596	90		
	646	90		
	696	90		
	796	90		
	796	90		
546	546	90		
	596	90		
	646	90		
	696	90		
	796	90		
	796	90		
	796	90		
596	596	90		
	646	90		
	696	90		
	796	90		
646	646	90		
	696	90		
	796	90		

N 51

Insulating Board $P = 600 \text{ N/mm}^2$

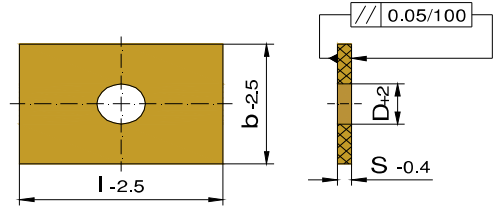
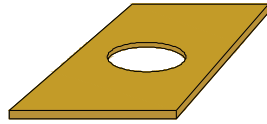

Ordering-Example:

1 Piece N51 246/496/8,5/90

Special Sizes Available On Request

Application Temperature: 200°C
Thermal Conductivity: $0,19 \text{ W/mk}$

Dense: $1,9 \text{ g/cm}^3$

b	l	S	D	€
246	496	8,5	90	
296	296		90	
	346		90	
	396		90	
	446		90	
	496		90	
	546		90	
	596		90	
	696		90	
346	346		90	
	396		90	
	446		90	
	496		90	
	546		90	
	596		90	
	696		90	
	796		90	
396	396		90	
	446		90	
	496		90	
	546		90	
	596		90	
	696		90	
	796		90	
	896		90	
446	446		90	
	496		90	
	546		90	
	596		90	
	696		90	
	796		90	
	896		90	
496	496		90	
	546		90	
	596		90	
	696		90	
	796		90	
	896		90	
	996		90	

b	l	S	D	€	
546	546	8,5	90		
	596		90		
	646		90		
	696		90		
	796		90		
	896		90		
	996		90		
	596	596		90	
		696		90	
646	596		90		
	696		90		
	796		90		
	896		90		
	996		90		
	696	696		90	
		796		90	
		896		90	
796	696		90		
	796		90		
	896		90		
	996		90		
	896	896		90	
		996		90	