

DIN

Push Locks

KZZ6

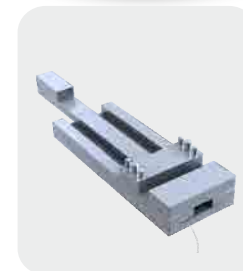

KZ Z6-1

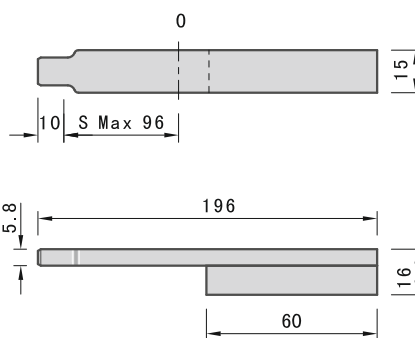
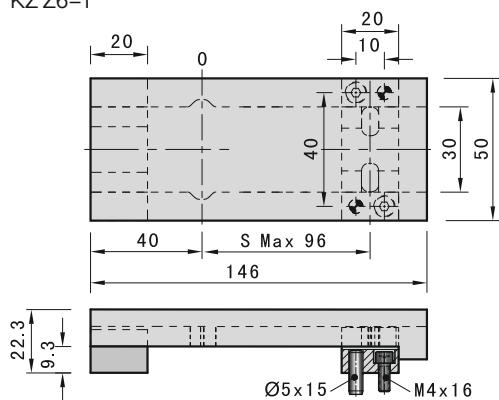

KZ Z6-15

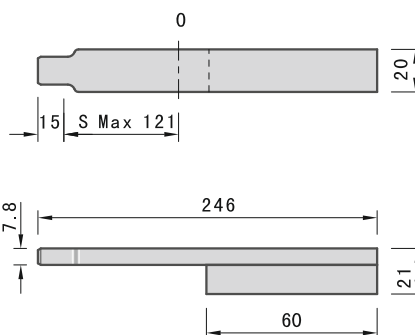
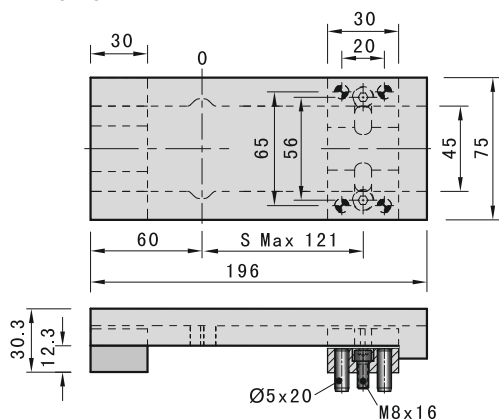

KZ Z6-2

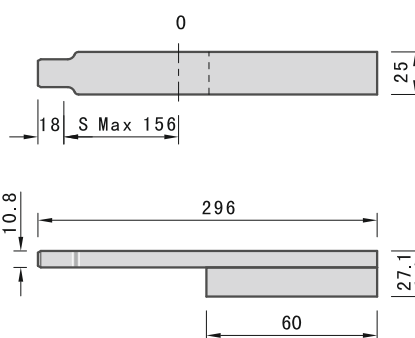
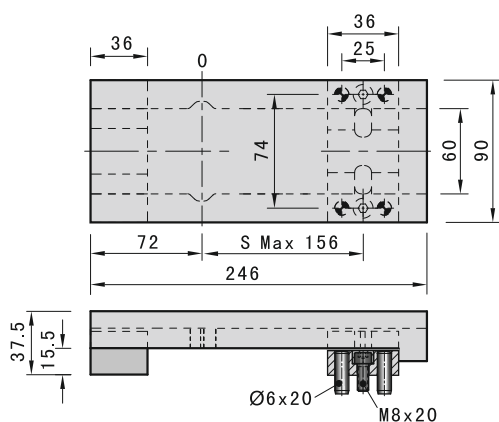



Push Locks

Product space chart:

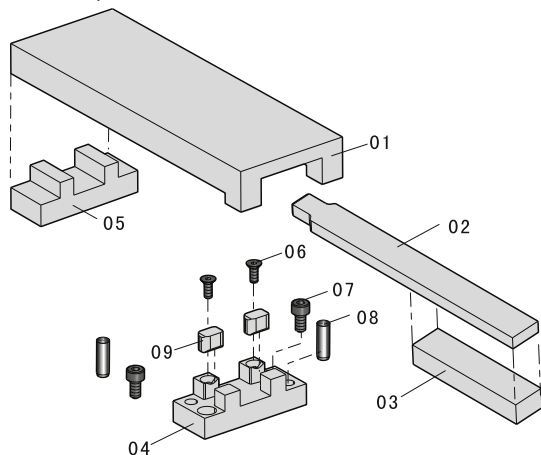

Installation Guidelines:

- This round latch lock is used to early return the ejector plate before mold closing to avoid mold damaged.
- A minimum 2 sets round latch locks must be mounted symmetrically in mold.
- Make sure the stroke of latch locks are same, otherwise, the uneven force will cause mold damaged.
- S is the maximum stroke of ZZ6 in mold. The final stroke could be confirmed by adjusting the latch housing (04) in use.

Functional chart:

