

RS 170

Il nuovo codice sarà fornito solo ad esaurimento del vecchio - The new code will be supplied only when the old will be out of stock - Der neue Kode wird geliefert nur wenn der alte nicht mehr im Lager ist - Le nouveau code sera fourni uniquement lorsque le vieux stock sera écoulé - El nuevo código será suministrado sólo cuando el viejo está fuera de stock - O novo código irá ser fornecido apenas quando o antigo esgotar stock

ACTIVE SAFETY



OSAS



USAS



OPAS



SKUDO



p. 241

* $F_{1i} =$

Isothermal end force at 100% Cu

p. 18

** $F_{1p} =$

Polytrophic end force at 100% Cu

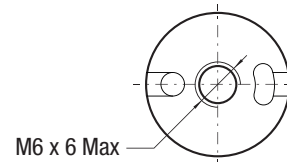
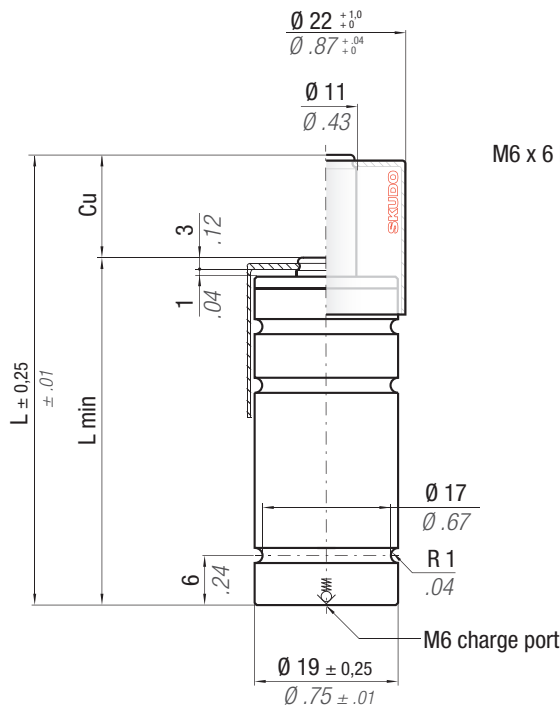
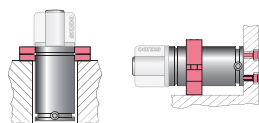

	$^{\circ}\text{F}$ 32 - 176	$^{\circ}\text{C}$ 0 - 80	ΔP $\pm 0,33\% / ^{\circ}\text{C}$	P max 180 bar 2610 psi	P min 20 bar 290 psi	S 0,95 cm ² 0,147 in ²	SPM ~ 40 - 100 (at 20°C)	Max Speed 1,8 m/s	Maintenance kit Disposable
--	--------------------------------------	------------------------------------	---	-------------------------------------	-----------------------------------	---	---------------------------------------	-----------------------------	--------------------------------------

CODE PHASING OUT from 05/2019	NEW	Cu		L		L min		F0 Initial force daN lb	F1i *		F1p **		V0		~Kg ~lb	PED 2014/68/EU	
		mm	inch	mm	inch	mm	inch		daN	lb	daN	lb	daN	lb			cm ³
RS 170 - 007 - B	RS 170 - 007 - C	7	0.28	50	1.97	43	1.69	170 ± 5%	239	537	271	609	3,0	0.18	0,06	0.13	✓
RS 170 - 010 - B	RS 170 - 010 - C	10	0.39	56	2.20	46	1.81		253	569	290	652	4,0	0.24	0,07	0.14	✓
RS 170 - 012 - B	RS 170 - 012 - C	12	0.47	60	2.36	48	1.89		260	585	300	674	4,0	0.24	0,07	0.15	✓
RS 170 - 016 - B	RS 170 - 016 - C	16	0.63	68	2.68	52	2.05		271	609	316	710	5,0	0.31	0,07	0.16	✓
RS 170 - 022 - B	RS 170 - 022 - C	22	0.87	80	3.15	58	2.28		281	632	331	744	7,0	0.43	0,08	0.17	✓
RS 170 - 029 - B	RS 170 - 029 - C	29	1.14	94	3.70	65	2.56		290	652	344	773	8,0	0.49	0,09	0.19	✓
RS 170 - 035 - B	RS 170 - 035 - C	35	1.38	106	4.17	71	2.80		295	663	351	789	10,0	0.61	0,09	0.21	✓
RS 170 - 047 - B	RS 170 - 047 - C	47	1.85	130	5.12	83	3.27		301	677	361	812	13,0	0.79	0,11	0.24	✓
RS 170 - 060 - B	RS 170 - 060 - C	60	2.36	156	6.14	96	3.78		306	688	368	827	16,0	0.98	0,12	0.27	✓
RS 170 - 072 - B	RS 170 - 072 - C	72	2.83	185	7.28	113	4.45		309	695	372	836	19,0	1.16	0,14	0.31	✓
RS 170 - 077 - B	RS 170 - 077 - C	77	3.03	195	7.68	118	4.65	310	697	374	841	21,0	1.28	0,15	0.32	✓	
RS 170 - 097 - B	RS 170 - 097 - C	97	3.82	235	9.25	138	5.43	313	704	378	850	25,0	1.53	0,17	0.37	✓	
RS 170 - 122 - B	RS 170 - 122 - C	122	4.80	285	11.22	163	6.42	315	708	382	859	31,0	1.89	0,19	0.43	✓	

WARNING REMOVE SKUDO

Upside down mounting

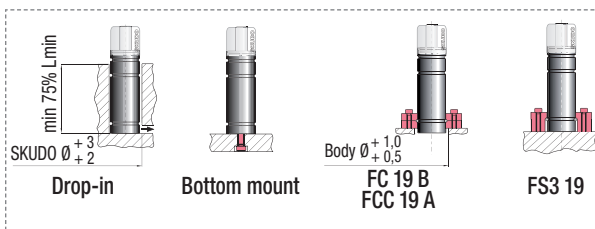

HOW TO ORDER



INSTALLATION GUIDELINE

