

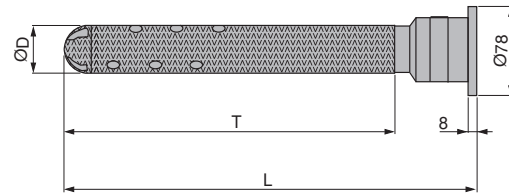

BW 500
Hollow Cutter
Strafor İşleme Takımı
Fräser

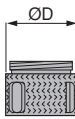

Form - W



Form - X

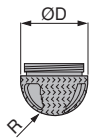

Form - Y

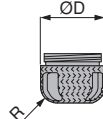

Form - Z

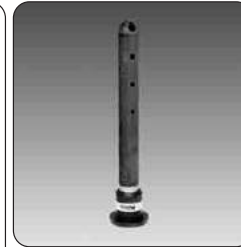
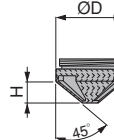

Milling Materials
Hard, brittle, expanded plastics :
PS /XPS, PU

Semi-hard to viscous expanded
plastics:
PE, PPE / EPP, PU

and others

GSB CODE:BW 500

BW HOLLOW CUTTERS

Code	ØD	T	L
BW 500.200-	15	120	190
BW 500.201-	20	200	270
BW 500.207-	20	250	320
BW 500.202-	30	200	270
BW 500.208-	30	250	320
BW 500.213-	30	300	370
BW 500.218-	30	350	420
BW 500.203-	40	200	270
BW 500.209-	40	250	320
BW 500.214-	40	300	370
BW 500.221-	40	350	420
BW 500.222-	40	400	470
BW 500.397-	40	450	520
BW 500.204-	45	200	270
BW 500.210-	45	250	320
BW 500.215-	45	300	370
BW 500.219-	45	350	420
BW 500.315-	45	400	470
BW 500.384-	45	450	520
BW 500.230-	45	500	570
BW 500.205-	50	200	270
BW 500.211-	50	250	320
BW 500.216-	50	300	370
BW 500.228-	50	350	420
BW 500.295-	50	400	470
BW 500.284-	50	450	520
BW 500.280-	50	500	570
BW 500.206-	60	200	270
BW 500.212-	60	250	320
BW 500.217-	60	300	370
BW 500.220-	60	350	420
BW 500.297-	60	400	470
BW 500.282-	60	450	520
BW 500.299-	60	500	570
BW 500.276-	60	600	670

HOLLOW CUTTER TIPS (Exchange tips)

Code	ØD
BW 500.430-15-	15
BW 500.430-20-	20
BW 500.430-25-	25
BW 500.430-30-	30
BW 500.430-40-	40
BW 500.430-45-	45
BW 500.430-50-	50
BW 500.430-60-	60

Order Example: (Hollow Cutters)

BW 500.Code-Form (R or H)

D=45, T=250 and Form=Y

Order Code: BW 500.210-YR10

Order Example: (Hollow Cutters Tips)

BW 500.430-D-Form

D=40, T=250, Form=Z, and H=25 mm

Order Code: BW 500.430-40-ZH25

Advantages :

Fast milling of patterns

Very good quality finishes

Provides high planning reliability ensuring quality products

Keep close tolerances

Continuous direct suction effectively removes chips internally through the hollow cutter by utilising a hollowshaft motor with a suction machine (suction milling)

Quickly exchangeable cutter tips

Special hardening guarantees a long service life

Dynamically balanced

Also available with integrated ISO or HSK adaptor