

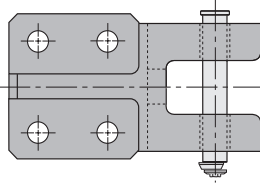

**STQ 40001**  
Lifting Brackets With Pins  
Taşıma Braketleri  
Tragwange Mit Tragbolzen

Form - A

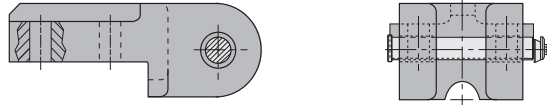

Form - B

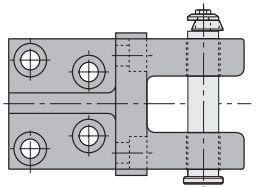
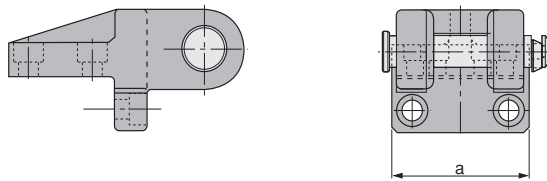

Material :  
CK45  
800 ÷ 1000 N/mm<sup>2</sup>

**WARNING !**  
For safety reasons, the weight of the tool has to be supported by just two lifting pins.

**Respect the max load**

**UYARI !**  
Güvenlik nedeniyle kalıp ağırlığı iki adet taşıma piminin taşıyabileceği maksimum yük miktarını aşmamalıdır.

**Maksimum yükü göz ardı etmeyiniz**

**ACHTUNG !**  
Aus Sicherheitsgründen achten Sie immer dass zwei Tragbolzen das gesamte Werkzeugs gewicht tragen müssen.

**Maximale Nutzlast beachten**

**FCA CODE:STQ 40001**

FCA Code

GR\_ST\_KG600  
GR\_ST\_KG1000  
GR\_ST\_KG2000  
GR\_ST\_KG4000  
GR\_ST\_KG7000

