



E24.64.105.G

Visual Locator Punch
Konum İz Zimbası
Endkontrollstempel

PSA Code

P785 283 005

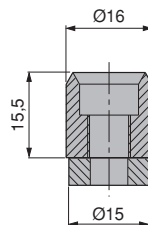

Material :
X153CrMoV12 T6
Hardened
HRc : 58 - 60

Washer
Material :
CK45

PSA CODE:E24.64.105.G



E24.65.000.G

Lifting Pins
Taşıma Milleri
Tragbolzen Mit Fallringsicherung

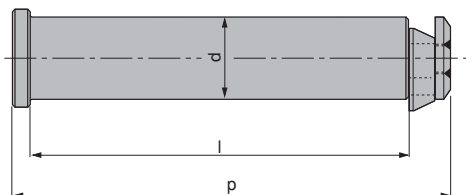

Material :
St 52

WARNING !
For safety reasons, the weight of the tool has to be supported by just two lifting pins.
Respect the max load

UYARI !
Güvenlik nedeniyle kalıp ağırlığı iki adet taşıma piminin taşıyabileceği maksimum yük miktarını aşmamalıdır.
Maksimum yükü göz ardı etmeyiniz

ACHTUNG !
Aus Sicherheitsgründen achten Sie immer dass zwei Tragbolzen das gesamte Werkzeugs gewicht tragen müssen.
Maximale Nutzlast beachten

PSA Code	Max. Load (Kg)	Max. Die Weight (Kg)	d	l	p
P 953 254 770	6000	12000	32	132	154
P 953 255 870	9000	18000	40	170	197,75
P 953 256 670	14000	28000	50	212	247,50
P 953 257 470	22500	45000	63	265	309

PSA CODE:E24.65.000.G