

ML 1800



sw

Il nuovo codice sarà fornito solo ad esaurimento del vecchio

The new code will be supplied only when the old will be out of stock

ACTIVE SAFETY



OSAS

Der neue Kode wird nur angegeben, wenn der alte nicht mehr lieferbar ist

Le nouveau code sera fourni uniquement lorsque le vieux stock sera écoulé

El nuevo código será suministrado sólo cuando se agoten las existencias del antiguo

O novo código irá ser fornecido apenas quando o antigo esgotar stock



USAS



OPAS

* $F_{1i} =$

Isothermal end force at 100% Cu

** $F_{1p} =$

Polytrophic end force at 100% Cu

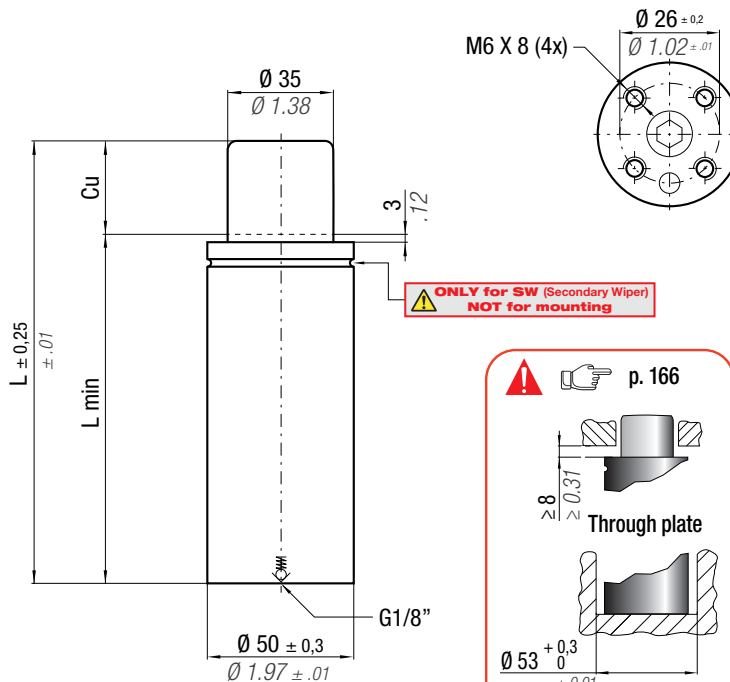

ONLY for SW (Secondary Wiper)
NOT for mounting

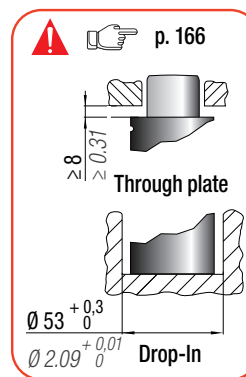

N ₂	0 - 80 °C 32 - 176 °F	ΔP ± 0,33 %/°C	P max 200 bar 2900 psi	P min 20 bar 290 psi	S 9,62 cm ² 1.491 in ²	SPM ~ 40 - 80 (at 20°C)	Max Speed 1,6 m/s 62,9 in/s	Maintenance kit 39BMML01800C										
CODE	PHASING OUT from 05/2019	NEW	Cu	L	L min	F₀ Initial force	F_{1i} * End force *	F_{1p} ** End force **	V₀									
			mm inch	mm inch	mm inch	daN lb	daN lb	daN lb	cm ³ in ³	~Kg ~lb								
ML 1800 - 015 - C	ML 1800 - 015 - D	15	0.59	95	3.74	80	3.15	1925	4327	2828	6358	3215	7227	57	3.46	0,76	1.68	✓
ML 1800 - 025 - C	ML 1800 - 025 - D	25	0.98	115	4.53	90	3.54	± 5%		3198	7189	3728	8381	75	4.56	0,85	1.87	✓
ML 1800 - 038 - C	ML 1800 - 038 - D	38	1.50	150	5.91	112	4.41	200 bar 2900 psi		3274	7359	3835	8621	110	6.69	1,01	2.23	✓
ML 1800 - 050 - C	ML 1800 - 050 - D	50	1.97	175	6.89	125	4.92	+20 °C +68 °F		3471	7802	4115	9252	133	8.10	1,12	2.47	✓
ML 1800 - 063 - C	ML 1800 - 063 - D	63	2.48	205	8.07	142	5.59			3568	8021	4254	9564	161	9.84	1,26	2.78	✓
ML 1800 - 080 - C	ML 1800 - 080 - D	80	3.15	245	9.65	165	6.50			3642	8188	4362	9805	200	12.18	1,44	3.17	✓

KIT FOR LINKING

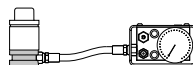

code: 39FML01800C



Seal (1x)

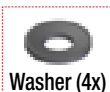

Washer (4x)



Screw (2x)



Bottom base (1x)



Valve (1x)

Instructions



Sostituire ogni 1.000.000 di cicli. REMPLACEZ à chaque million de cycles. Reemplazar cada 1 millón de ciclos. Nach 1 Mio. Hübe austauschen. Substituir a cada 1 milhão de ciclos.

Bottom base dimension

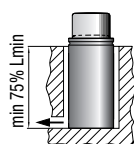
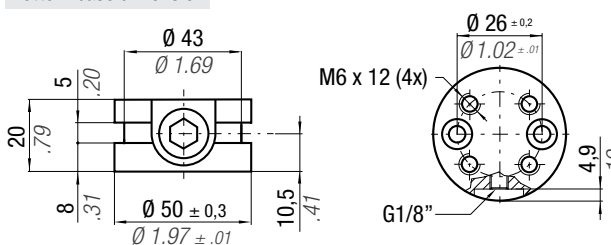

Drop-In



Bottom mount

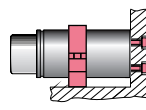

FSA 50 - FSD 50
FSE 50

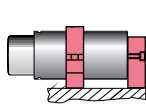

FSD 50 + R 50 A
FSE 50 + R 50 A

HOW TO ORDER



INSTALLATION GUIDELINE

