

MP 150

ACTIVE SAFETY



OPAS

* $F_{1i} =$

Isothermal end force at 100% Cu

** $F_{1p} =$

Polytropic end force at 100% Cu

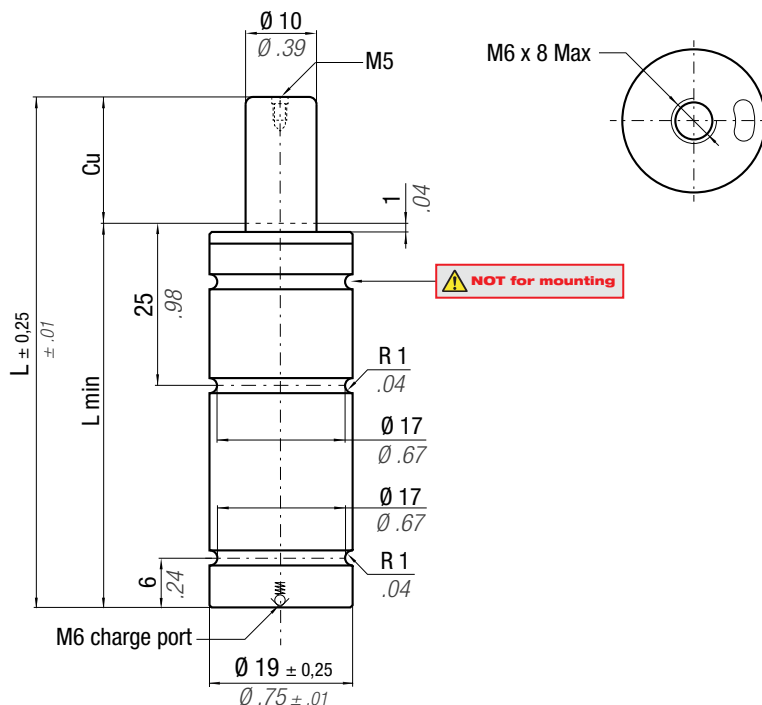

	0 - 80 °C 32 - 176 °F	ΔP ± 0,33 %/°C	P max 191 bar 2770 psi	P min 20 bar 290 psi	S 0,79 cm ² 0,122 in ²	SPM ~ 40 - 80 (at 20°C)	Max Speed 1,8 m/s 70,8 in/s	Maintenance kit Disposable
CODE	Cu	L	L min	F0	F _{1i} *	F _{1p} **	V0	
	mm inch	mm inch	mm inch	Initial force daN lb	End force * daN lb	End force ** daN lb	cm ³ in ³	~Kg ~lb
MP 150 - 010 - A	10 0.39	75 2.95	65 2.56	150 337 ± 5% 191 bar 2770 psi + 20 °C +68 °F	185 416	201 452	5,2 0.32	0,09 0.20
MP 150 - 015 - A	15 0.59	85 3.35	70 2.76		195 438	214 481	6,4 0.39	0,09 0.20
MP 150 - 020 - A	20 0.79	95 3.74	75 2.95		203 456	225 506	7,5 0.46	0,10 0.22
MP 150 - 025 - A	25 0.98	105 4.13	80 3.15		209 470	234 526	8,6 0.52	0,11 0.24
MP 150 - 032 - A	32 1.26	120 4.72	88 3.46		214 481	241 542	10,4 0.63	0,11 0.24
MP 150 - 038 - A	38 1.50	135 5.31	97 3.82		214 481	241 542	12,4 0.76	0,12 0.26
MP 150 - 045 - A	45 1.77	150 5.91	105 4.13		217 488	245 551	14,1 0.86	0,13 0.29
MP 150 - 050 - A	50 1.97	160 6.30	110 4.33		220 495	249 560	15,3 0.93	0,14 0.31
MP 150 - 056 - A	56 2.20	175 6.89	119 4.69		219 492	248 558	17,2 1.05	0,14 0.31
MP 150 - 063 - A	63 2.48	190 7.48	127 5.00		221 497	251 564	19,0 1.16	0,15 0.33
MP 150 - 080 - A	80 3.15	220 8.66	140 5.51	231 519	264 593	22,0 1.34	0,17 0.37	

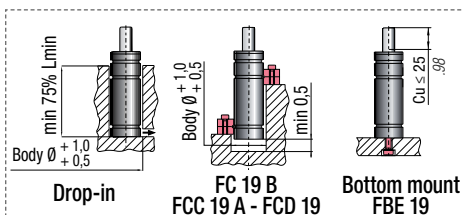

HOW TO ORDER



INSTALLATION GUIDELINE

