

## MP 500



\*  $F_{1i} =$

Isothermal end force at 100% Cu

p. 16

\*\*  $F_{1p} =$

Polytropic end force at 100% Cu

**ACTIVE SAFETY**



OSAS



USAS

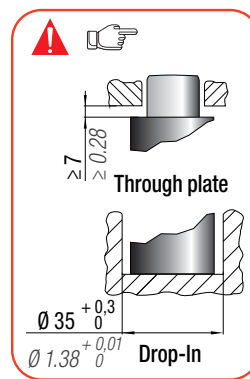
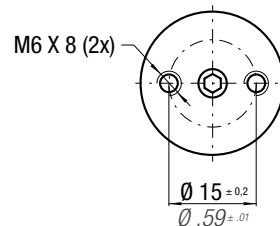
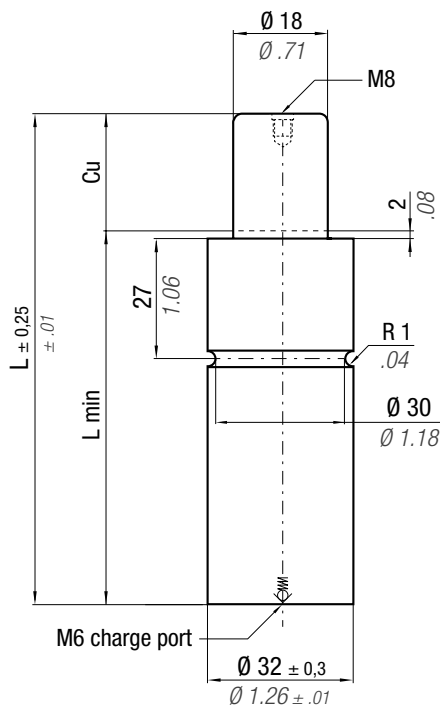

CODE	N <sub>2</sub>	0 - 80 °C 32 - 176 °F	ΔP ± 0,33 %/°C	P max 197 bar 2857 psi	P min 20 bar 290 psi	S 2,54 cm <sup>2</sup> 0,394 in <sup>2</sup>	SPM ~ 40 - 80 (at 20°C)	Max Speed 1,6 m/s 62,9 in/s	Maintenance kit			
									Disposable			
				Cu	L	L min	F <sub>0</sub>	F <sub>1i</sub> *	F <sub>1p</sub> **	V <sub>0</sub>	PED	
				mm inch	mm inch	mm inch	Initial force daN lb	End force * daN lb	End force ** daN lb	cm <sup>3</sup> in <sup>3</sup>	~Kg ~lb	2014/68/EU
MP 500 - 010 - A				10 0.39	75 2.95	65 2.56	500 1124 ± 5% 197 bar 2857 psi + 20 °C +68 °F	714 1605	798 798	10,7 0.65	0,29 0.64	✓
MP 500 - 015 - A				15 0.59	85 3.35	70 2.76		770 1731	873 873	13,6 0.83	0,31 0.68	✓
MP 500 - 020 - A				20 0.79	95 3.74	75 2.95		809 1819	928 928	16,5 1.01	0,33 0.73	✓
MP 500 - 025 - A				25 0.98	105 4.13	80 3.15		839 1886	970 970	19,5 1.19	0,34 0.75	✓
MP 500 - 032 - A				32 1.26	120 4.72	88 3.46		859 1931	997 997	24,1 1.47	0,37 0.82	✓
MP 500 - 038 - A				38 1.50	135 5.31	97 3.82		849 1909	984 984	29,1 1.78	0,40 0.88	✓
MP 500 - 045 - A				45 1.77	150 5.91	105 4.13		862 1938	1002 1002	33,6 2.05	0,43 0.95	✓
MP 500 - 050 - A				50 1.97	160 6.30	110 4.33		875 1967	1020 1020	36,6 2.23	0,45 0.99	✓
MP 500 - 056 - A				56 2.20	175 6.89	119 4.69		866 1947	1008 1008	41,6 2.54	0,48 1.06	✓
MP 500 - 063 - A				63 2.48	195 7.68	132 5.20		844 1897	977 977	48,6 2.96	0,52 1.15	✓
MP 500 - 080 - A				80 3.15	230 9.06	150 5.91	869 1954	1012 1012	59,1 3.61	0,59 1.30	✓	

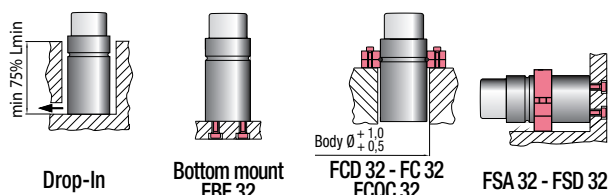

### HOW TO ORDER



### INSTALLATION GUIDELINE

