

## A - EW

### BLOCK CYLINDER

Special Sizes Available On Request.

3D Insertion Reference

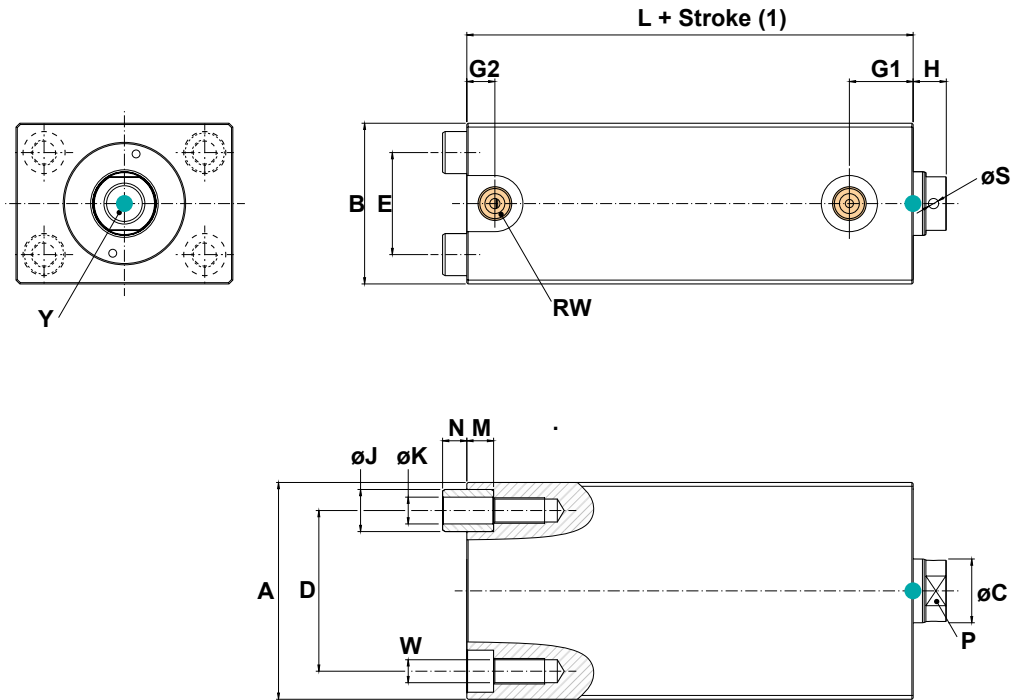

#### HOW TO ORDER

Reference: **A0EW025-090P2S1**

| TYPE | OPERATION MODE | FIXING STYLE | PISTON $\varnothing$ | STROKE $\pm 0.5$ (1) |      | PURGE (2) | SENSOR (2) | A   | B   | C  | D   |
|------|----------------|--------------|----------------------|----------------------|------|-----------|------------|-----|-----|----|-----|
|      |                |              |                      | MIN.                 | MAX. |           |            |     |     |    |     |
| A    | 0              | EW           | 016                  | 010                  | 100  | P0<br>Px  | S0<br>Sx   | 60  | 35  | 10 | 40  |
|      |                |              | 025                  | 010                  | 120  |           |            | 65  | 45  | 16 | 50  |
|      |                |              | 032                  | 010                  | 150  |           |            | 75  | 55  | 20 | 55  |
|      |                |              | 040                  | 020                  | 160  |           |            | 85  | 63  | 25 | 63  |
|      |                |              | 050                  | 020                  | 180  |           |            | 100 | 75  | 32 | 76  |
|      |                |              | 063                  | 020                  | 180  |           |            | 125 | 95  | 40 | 95  |
|      |                |              | 080                  | 020                  | 180  |           |            | 160 | 120 | 50 | 120 |
|      |                |              | 100                  | 020                  | 180  |           |            | 200 | 150 | 60 | 158 |

STROKE (1) Can be ordered in multiples of 10mm, between Min. and Max. values.

PURGE / SENSOR(2) Replace x by FACE number.

## A - EW FIXING STYLE

Special Sizes Available On Request.

3D Insertion Reference

### PURGE / SENSOR (2) POSITION ORDERING

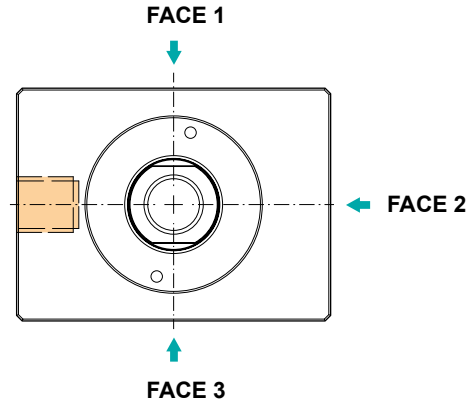

**P0:** Without Purge  
**Px:** Purge in FACE x  
Replace x by FACE number

### SENSOR AND SENSOR ASSEMBLY KIT MUST BE ORDERED SEPARATELY

**S0:** Without Sensor  
**Sx:** Sensor in FACE x  
Replace x by FACE number

| E   | G1 | G2 | H ±0.5 | J    | K    | L  | M    | N   | P  | RW   | S | W      | Y      |
|-----|----|----|--------|------|------|----|------|-----|----|------|---|--------|--------|
| 22  | 18 | 15 | 8      | 10.5 | 6.5  | 43 | 6.5  | 5.5 | 8  | 1/4" | - | M6x12  | M6x12  |
| 30  | 20 | 13 | 10     | 13.5 | 8.5  | 48 | 8.5  | 7.5 | 13 | 1/4" | 3 | M8x16  | M10x15 |
| 35  | 23 | 11 | 12     | 16.5 | 10.5 | 51 | 10.5 | 9.5 | 17 | 1/4" | 4 | M10x20 | M12x15 |
| 40  | 25 | 11 | 13     | 16.5 | 10.5 | 55 | 10.5 | 9.5 | 21 | 1/4" | 4 | M10x20 | M16x25 |
| 45  | 27 | 13 | 14     | 18.5 | 13   | 65 | 13   | 11  | 26 | 1/4" | 4 | M12x25 | M20x30 |
| 65  | 28 | 16 | 18     | 25   | 17   | 72 | 17   | 15  | 32 | 1/2" | 5 | M16x32 | M24x35 |
| 80  | 37 | 17 | 22     | 31   | 21   | 84 | 21   | 19  | 41 | 1/2" | 5 | M20x40 | M30x50 |
| 108 | 40 | 20 | 22     | 37   | 25   | 90 | 25   | 23  | 52 | 1/2" | 5 | M24x50 | M36x60 |